

evo SUITES®

*evosuites.com*

PRECISION . SUSTAINABLE . ANYWHERE

Strategic Collaboration :



Thoughtfully designed modular suites & homes installed move-in ready, complete with modern Scandinavian design furnishing, TOTO quality bath fixtures, KING KOIL sleep comfort, REC solar day power, and 3M tap ready drinking water.

- Advanced Home Technology - smart TVs, thermostats to keyless locks. Smart Sensor lighting & dimmers throughout.
- Built on the foundation of sustainable design & construction to ethical maintenance free upkeep.
- \* Designs to meet the lifestyle aspirations of today whilst building in mind the environmental sustainability for generations to come.

## evo 1 - The Suite



This is a patented product and imitation is prohibited.

**\*Roof mounted solar panels**









#SUSTAINABLE #ENERGY EFFICIENT  
#SOLAR POWER #CIRCULAR CONSTRUCTION #UPCYCLING  
#ECO #DECONSTRUCTION #SUSTAINABLE LIVING #CIRCULAR DESIGNS  
#REUSABLE #ENVIRONMENTAL FOOTPRINT #REVERSE ENGINEERING  
#SUSTAINABLE SOURCING #OFF-GRID DESIGNS

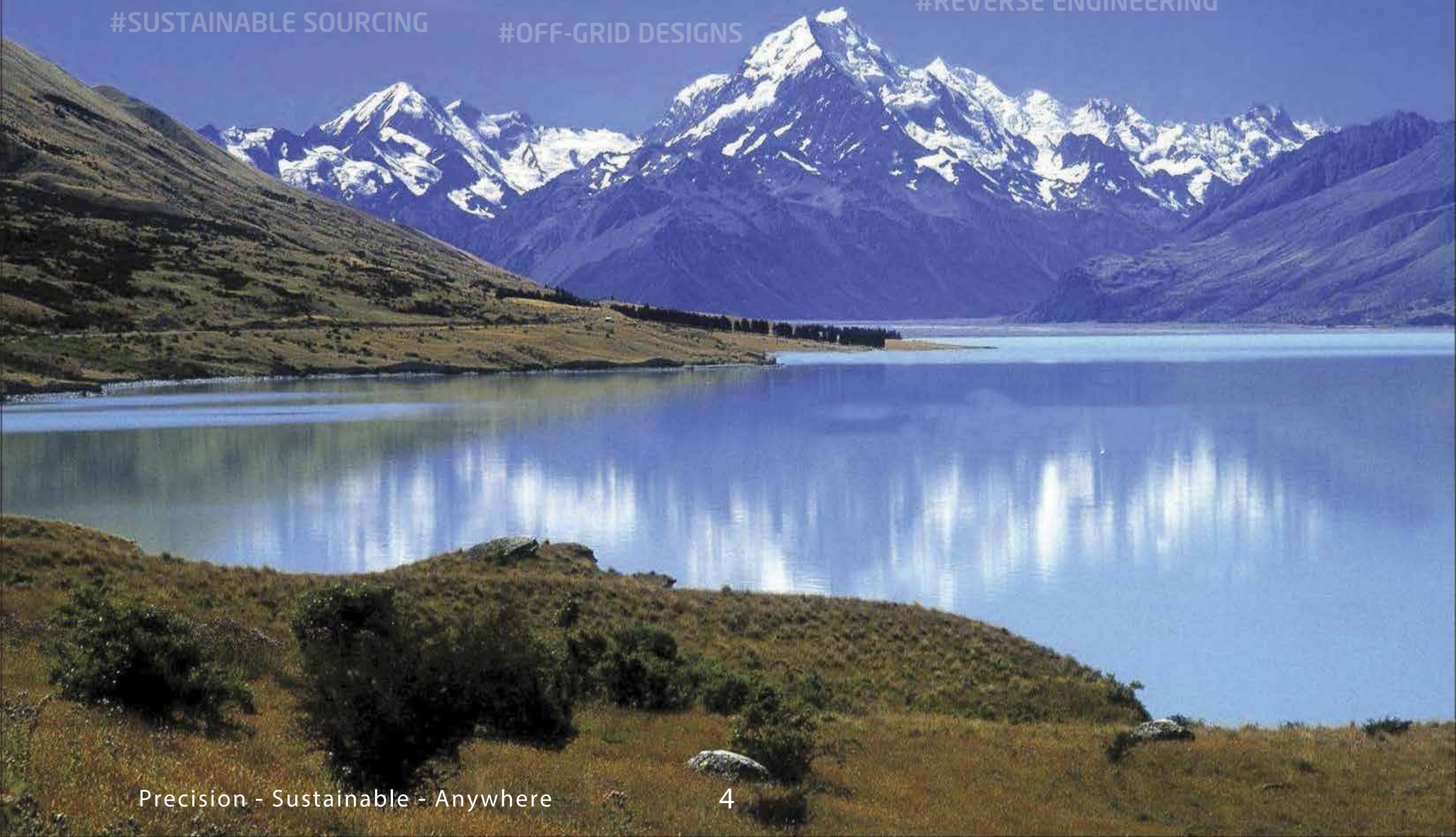







## Why are EVO Suites so Advanced & Sustainable ?

### Built for deconstruction, not demolition

Prefabricated & Modular buildings all but eliminate waste generated from demolition. Modular building systems are a prime example of recycle, repurpose and reuse.

EVO Units are Factory prefabrication, allowing **10 -15 day** on-site assembly with very low environmental impact, **eliminating construction noise, dust**, and building materials discarded on project site. Most importantly most components are recyclable.

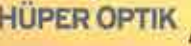
### Just a few of the key standard features you will find with EVO Suites:

- Smart Air Flow  Building Design ( Limit AC Usage)
-  **V-KOOL** Smart window cooling &  **HUPER OPTIK** , to reduce AC power consumption during peak sunlight hours.
-  EVO specially chosen smart low wattage use electrical appliances like LG Dual Cool Eco Inverter AC units. 70 Percent more efficient and 40 percent more cooler with variable watt control. Minimum noise pollution for compressor and interior unit. Built in air purifier
-  **REC** Solar roof mount panels installed on each unit. \*(Hybrid Design) Europe's most advance solar company



Solar Roof Top Water Heater included with **Offgrid Suites**







**DESIGN - PRECISION**







## LIGHTER & MORE NATURAL

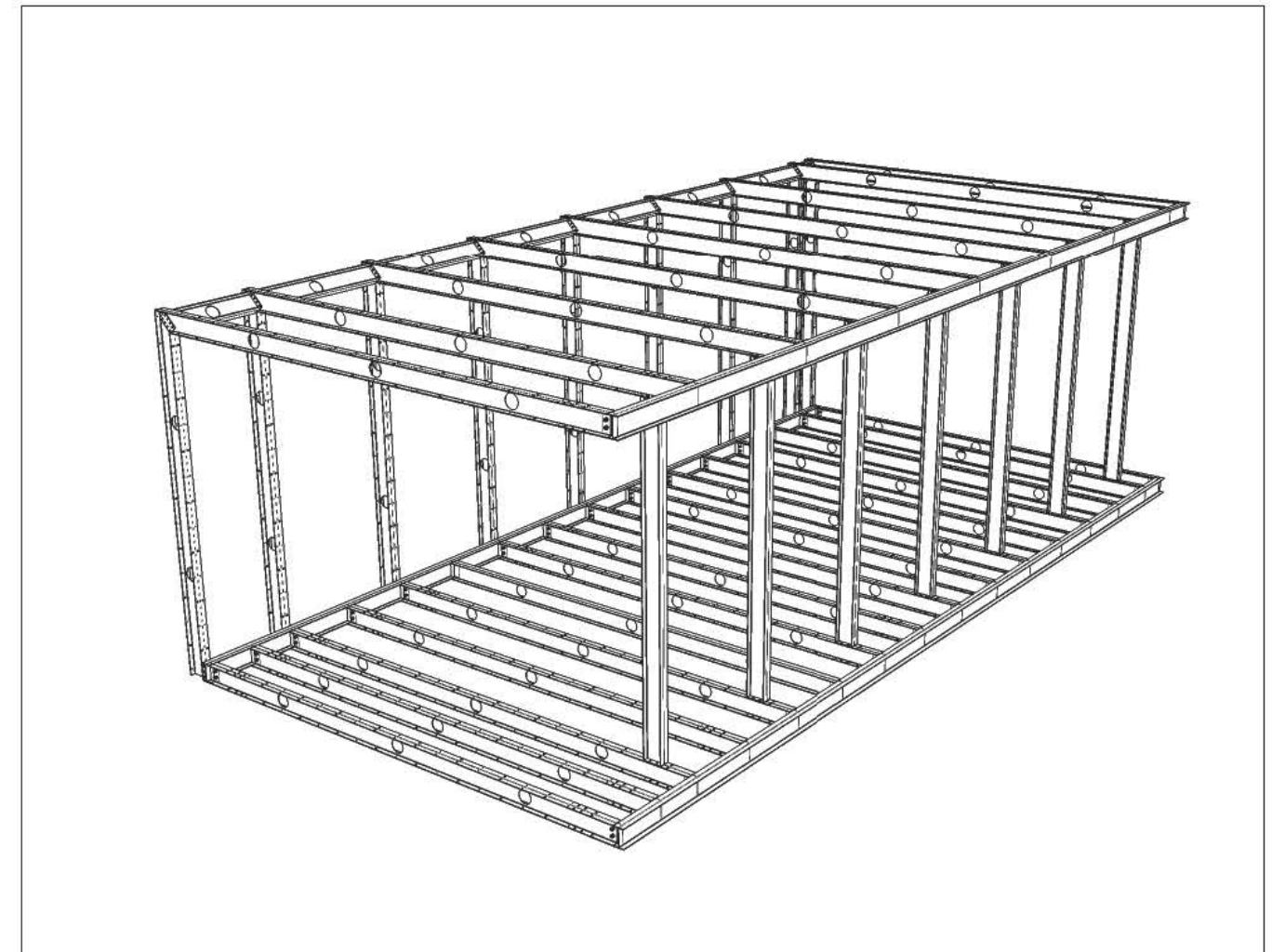
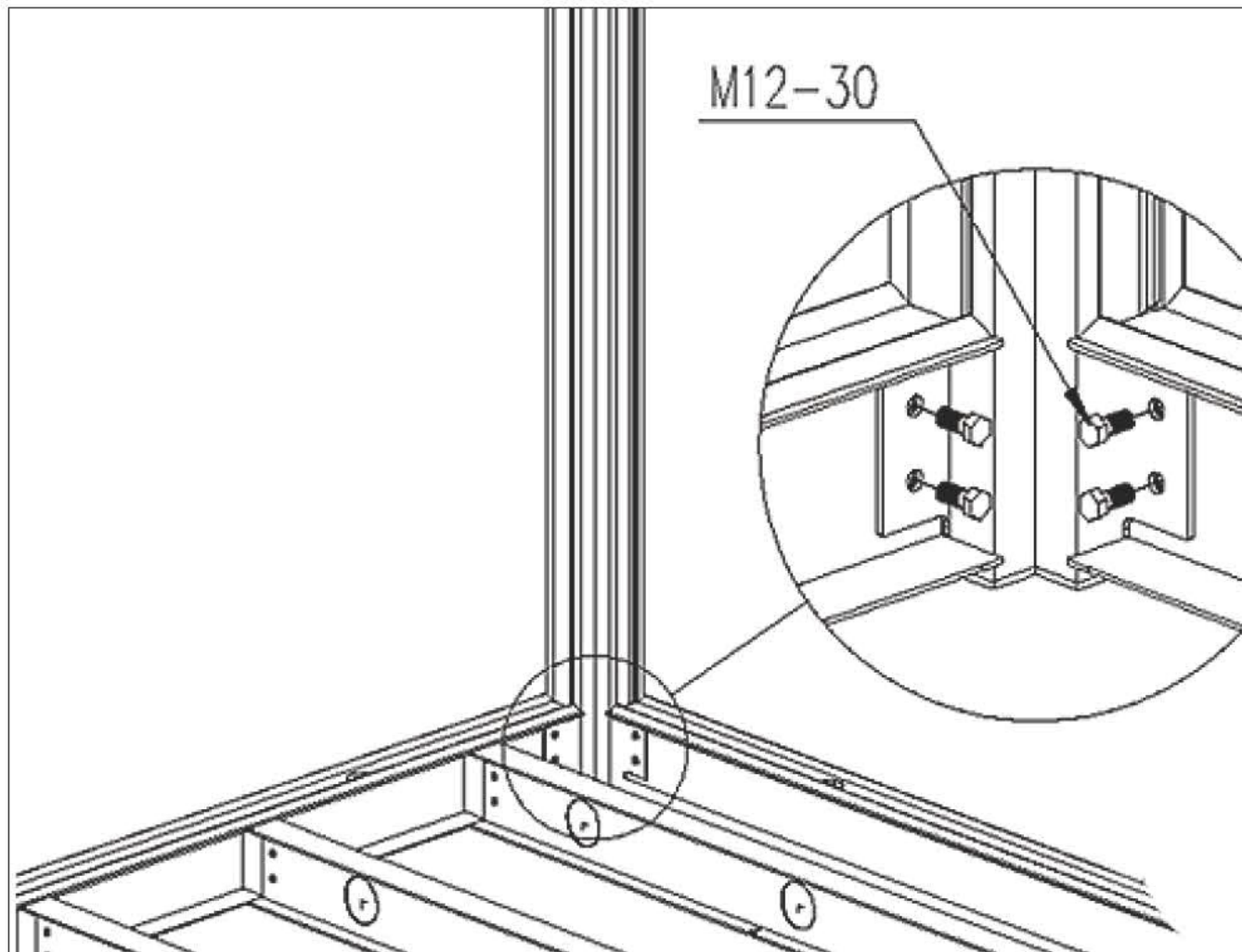

### PROMPT ASSEMBLY

The evo 1 is solely consisted of standard aluminium alloy components, able to be assembled on the spot without using any heavy construction cranes. No construction 'noise pollution', no environmental impact as conventional construction sites



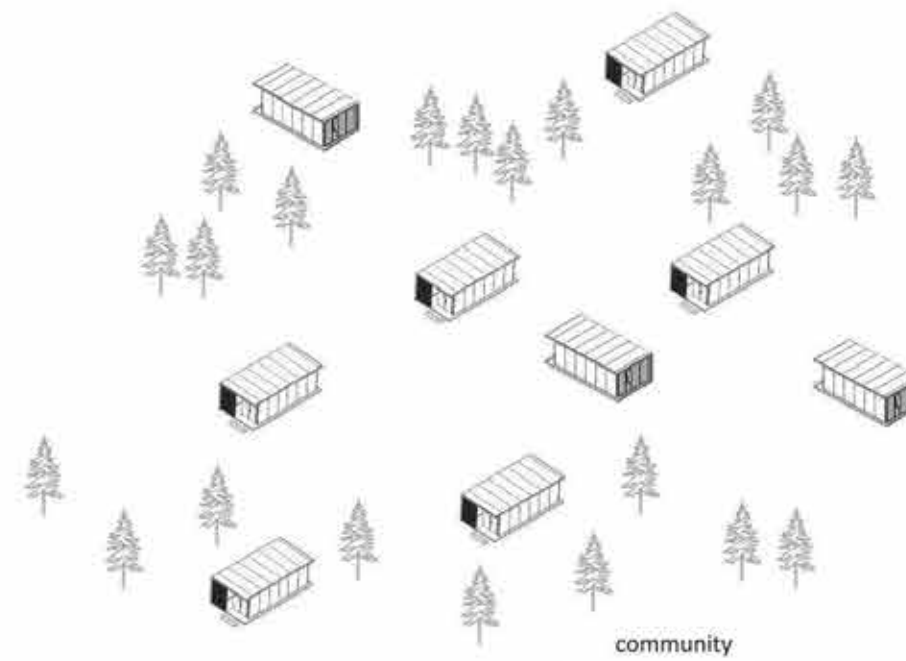
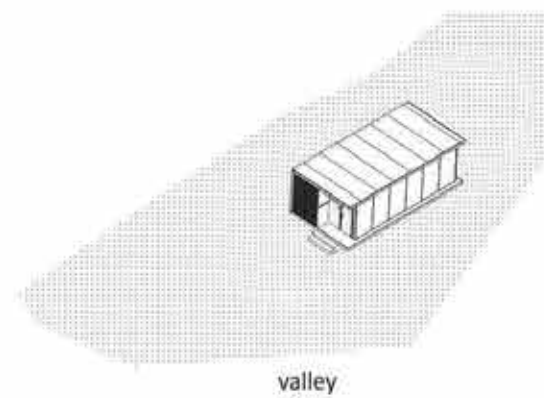
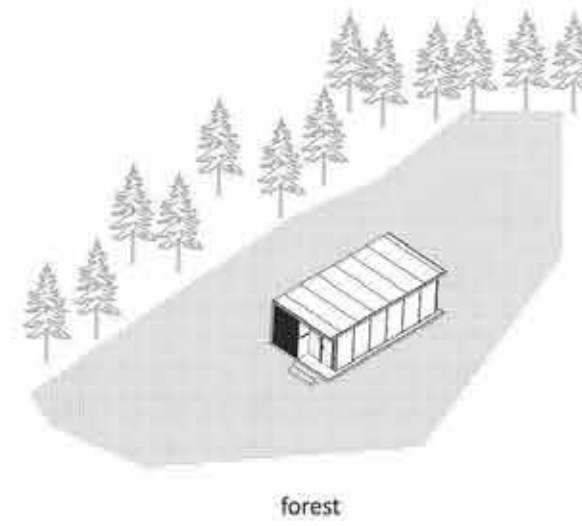
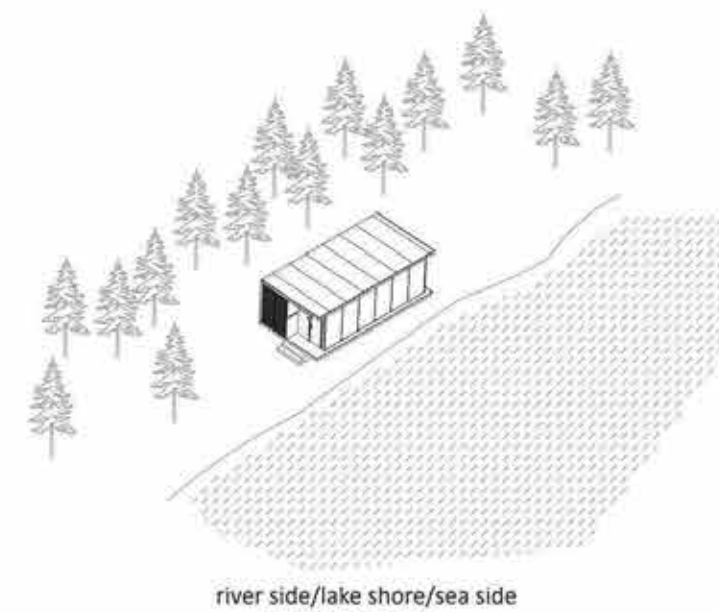

## LIGHT WEIGHT: EXPLORE NATURE FREELY

High mountains, lakeside or countrysides, the light weight of each component allows evo to be easily carried and assembled anywhere.



# CLOSER ENCOUNTER WITH NATURE

Off-grid living made easy.



\*Off-grid power solar storage power pack  
available in all evo models.



# NATURE-FRIENDLY

Protecting the earth's surface, and minimizing its footprint, the evo 1 adopts ground screws or prefab concrete footings for its foundation to avoid harming the environment in scenic areas thus protecting Nature.









### PANORAMIC CURTAIN CLASS WALLS

Half of the large curtain walls are made of curtain wall glass to expand the vision to the largest extent, giving you a panoramic view.





### **HIDDEN BATHROOM DESIGN**

The Bathroom is integrated with the closet & hidden pantry providing privacy and plenty of storage. The Independent toilet and shower are designed for two people to use simultaneously.

\*Privacy frost glass optional.



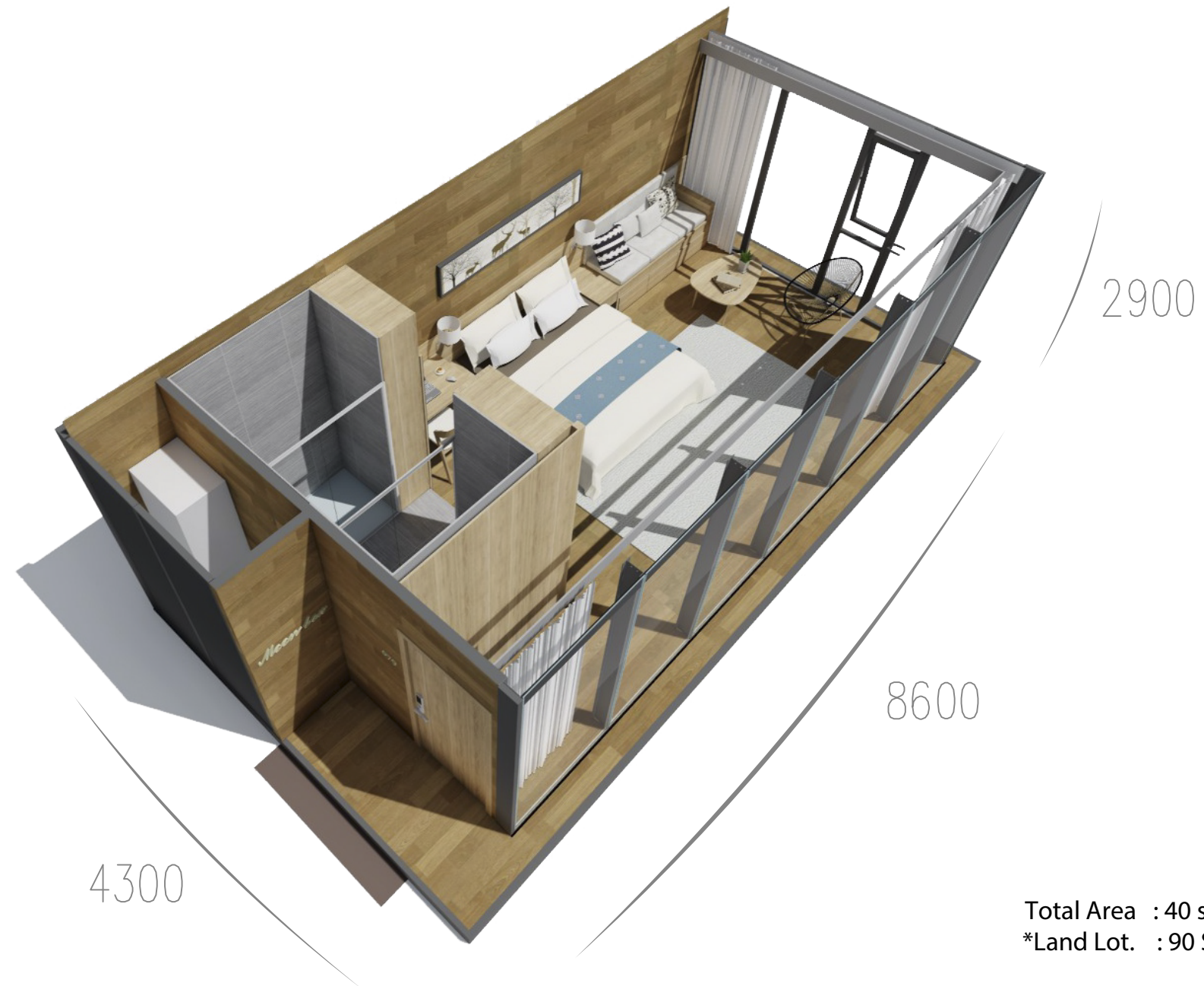

Total Area : 40 sqm / 430 sqft  
 \*Land Lot. : 90 Sqm / 968 sq ft.

1 Living Room . Bedroom . 1 Bathroom  
 Build Application : Grassland, Lakeside, Mountain,  
 Riverside, Seaside, Desert



# evo 1

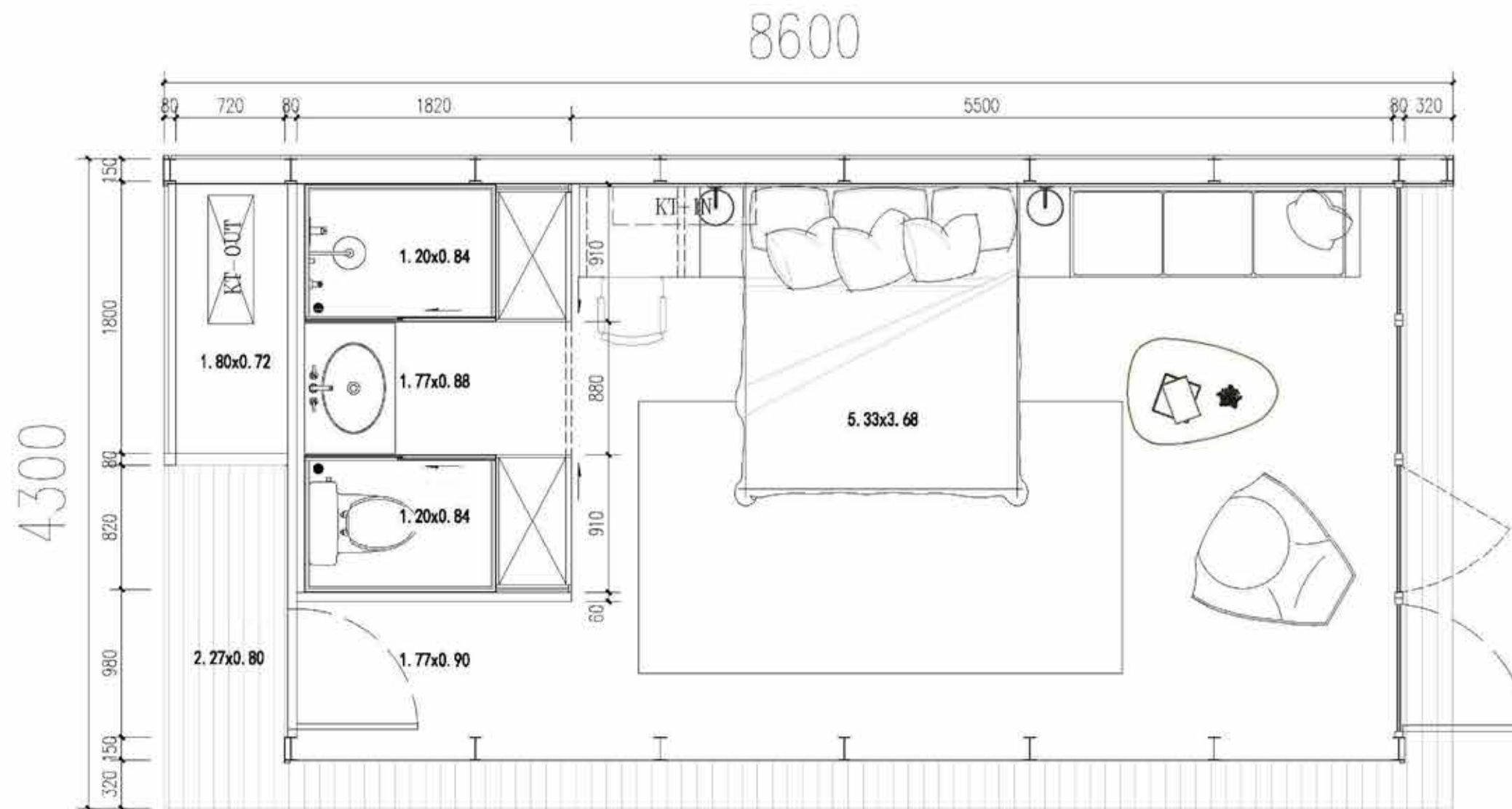

STANDARD FLOOR PLAN

## Interior Color Option



Forest Brown \*Paneling



Resort White \*



Light Faux Wood \*



## **evo** \*Hybrid Prefab/ Modular Suites & Home

- \* Ideal for short term land use \*leases land
- \* Temporary Housing Solutions
- \* Short term & Long Term Low Cost Turn-Key Housing Option
- \* Transportable \*Relocatable
- \* Off Plan preDesigned unites ready in 90 days or less
- \* Can be delivered anywhere in South East Asia or North America, Europe
  
- \* 10 Year Building & Workmanship warranty
- \* 3 Year Warranty on Appliances & Electrical
- \* 10 Year LG Dualcool AC inverter \*compresor warranty
- \* 25 Year Solar panel product and performance
- \* 12 Year Solar inverter product warranty
- \* Local Installation Services provided in 25 Countries \* Inquire for more details

### **Performance & Integrity & Lifespan**

= Class 8 earthquake resistance, anti-typhoon 12, anti-noise 68DB, fire A grade, service life 50 years

**PT. EVOLUSI PESONA LESTARI**  
**Nakula Plaza, Jl Nakula, Legian**  
**Kuta, Bali 80361**  
**[ask@evolutionsuites.com](mailto:ask@evolutionsuites.com)**  
**[www.evolutionsuites.com](http://www.evolutionsuites.com)**



CONFIGURATION EVO 1

Categories	Configurations	Brands	Standard	Premium
FRAMEWORK SYSTEM				
Frameworks	patented aviation aluminum framework system	evo	●	●
	patented connection locks		●	●
External walls	Multi-layer complex integrated wallboard with heat preservation and insulation functions	evo	●	●
	UV Resistance Advanced Composite HoneyComb flex-cladding (all-weather resilient) Aluminium		—	—
Internal walls	Multi-layer complex integrated wallboard with heat preservation and insulation functions	Galuminium	●	●
Doors&windows	Curtain walls made of tempered glass		●	●
	Curtain windows made of tempered glass		●	●
Floor	Composite baseplates		●	●

BATHROOM

Bathroom	Wash Sink	TOTO	●	●
	Eco Wash Lux toilet	TOTO	●	●
	Shower head package	TOTO	●	●
	Integrated cupboard		—	○

ELECTRICAL EQUIPMENT

Water heater	Water heater (Germany)	STIEBEL ELTRON	—	●
Air conditioning	AC Dual Cool SMART Eco Inverter 1.5PK	LG	—	●
Ventilation system	Ventilation	LG	—	●
Television	LG Smart ULTRA 43" HD	LG	—	●
Smoke exhauster	Smoke exhauster		evo 3 only	○
Pantry Fridge	50 Litre	Electrolux	—	○
Coffee Machine		Nespresso	—	●
Microwave	Bake / micro	Electrolux	—	○
			—	○

INTELLIGENCE SYSTEM

Intelligence system	Smart door lock	Evo	●	●
	Intelligent gateway		—	○
	Intelligent sensor		—	○
	Intelligent switch		—	○
	Intelligent background music system		—	○
	Intelligent safeguard system		—	○
	Intelligent hotel management system		—	○
	Voice control system		—	○
	IP CCTV entrance camera		—	●

Categories	Configurations	Brands	Standard	Premium
Interior				
Stair system	evo 3 only		—	○
Handrail	evo 3 only		—	○
			—	○
Equipment room	Integrated equipment room		—	○
Skylight	Skylight	The PANORAMA Edition only		
			●	●
			—	○
Lighting	LED Ceiling lamp		●	●
	Bathroom lamps		●	●
	LED Entrance lamps		●	●

Furnishing & Etc

Furniture	Standard Queen - size mattress	King Koll	—	●
	Bed side tables	evo	—	●
	Leisure sofa	evo	—	●
	Coffee Table	evo	—	●
	Multi-functional integrated desk & chair	evo	—	●
	Safety Deposit Box		—	●
	Carpet		—	○
	Rolling Sunscreen Blinds	TOSO Japan	—	●
	Curtain	TOSO	—	●
	Lux Curtain fabric w/ Blackout		—	●

\* The above options are for reference only. ●Included ○Excluded

\*Luxury Edition request price list.

www.evosuites.com





# Show Units







**Test Build ( Malaysia )**





Show Unit ( Bali )



**PRECISION . SUSTAINABLE . ANYWHERE**

***evosuites.com***





evo SUITES

*evosuites.com*

PRECISION . SUSTAINABLE . ANYWHERE

Vision Partners :        