

evo SUITES®

*evosuites.com*

PRECISION . SUSTAINABLE . ANYWHERE

Strategic Collaboration :



# evo 3 - The Loft



This is a patented product and imitation is prohibited.



Blending in with the natural scenery,  
evo 3 with its dynamic mirrored metallic cladding







Something to reflect on, both imagination  
and technology has propelled facades /  
exterior paneling beyond the 21st century.

"mirroring the energy of the surrounding and  
capturing the swaying of trees and shifting shapes and  
shadow as the Sun & Clouds cross the sky"



#ECO LOGICAL LIVING

#HYBRID LIVING

#INOVATION

#OFFGRIND DESIGN

#UPCYCLING

#CIRCULAR ARCHITECTURE

#OFFGRIND LIVING

#SUN POWER

#RENEWABLE ENERGY

#SUSTAINABLE CONSTRUCTION

#MINIMALISM

#SUSTAINABLE LIVING

#NATURE FRIENDLY

#ANYWHERE









## Why are EVO Suites so Advanced & Sustainable ?

### Built for deconstruction, not demolition

Prefabricated & Modular buildings all but eliminate waste generated from demolition. Modular building systems are a prime example of recycle, repurpose and reuse.

EVO Units are Factory prefabrication, allowing **10 -15 day** on-site assembly with very low environmental impact, **eliminating construction noise, dust**, and building materials discarded on project site. Most importantly most components are recyclable.

### Just a few of the key standard features you will find with EVO Suites:

- Smart Air Flow  Building Design ( Limit AC Usage)
-  **V-KOOL™** Smart window cooling &  **HUPER OPTIK** , to reduce AC power consumption during peak sunlight hours.
-  EVO specially chosen smart low wattage use electrical appliances like LG Dual Cool Eco Inverter AC units. 70 Percent more efficient and 40 percent more cooler with variable watt control. Minimum noise pollution for compressor and interior unit. Built in air purifier
-  **REC** Solar roof mount panels installed on each unit. \*(Hybrid Design) Europe's most advance solar company



\*Solar Roof Top Water Heater included with **Offgrid Suites**





**DESIGN - PRECISION**





The design of the evo 3 "The Loft " An Australian architecture masterpiece. Was inspired by clear and angular crystals and the adaption of double layered tempered reflective cladding;

"part art installation, part camouflaged hideaway with the appearance changing with the seasonal weather, by day by hour".





\*Roof mounted solar panels



Powered by:







## REFINEMENT

The evo 3 loft exterior is consisted of a specialize mirrored reflective double tempered "rock" glass, while its interior adopts a more natural wood finish available in 3 diffrent colour options to match decor.













\*Off-grid power solar storage power pack  
available in all evo models.





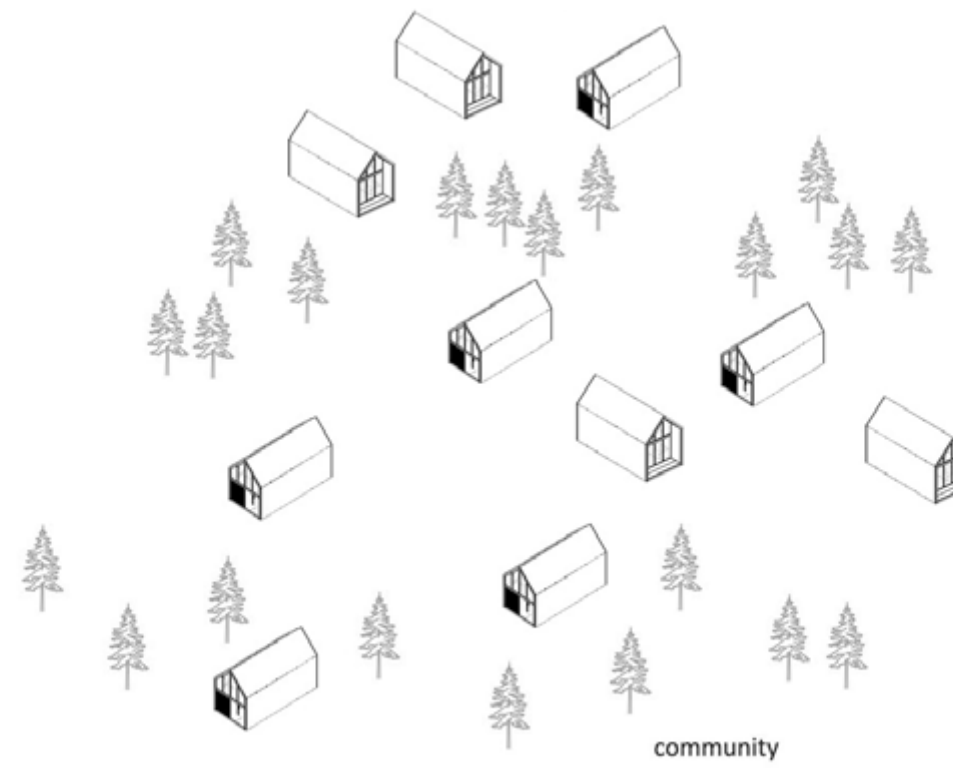
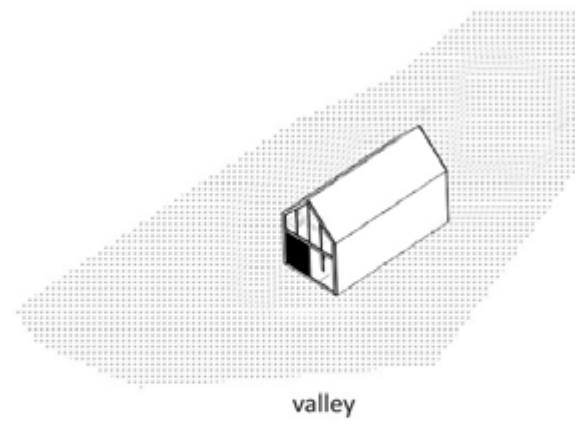
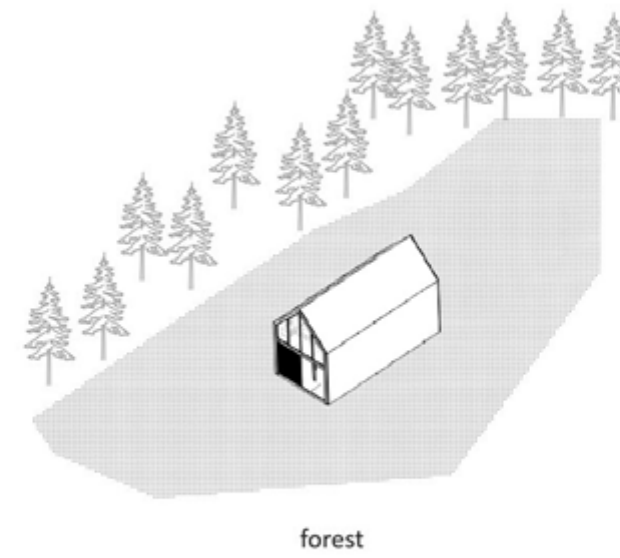

## ANYWHERE ASSEMBLY

The evo 3 is able to be assembled on the spot, that means building a beautiful cabin / hideaway within days not months



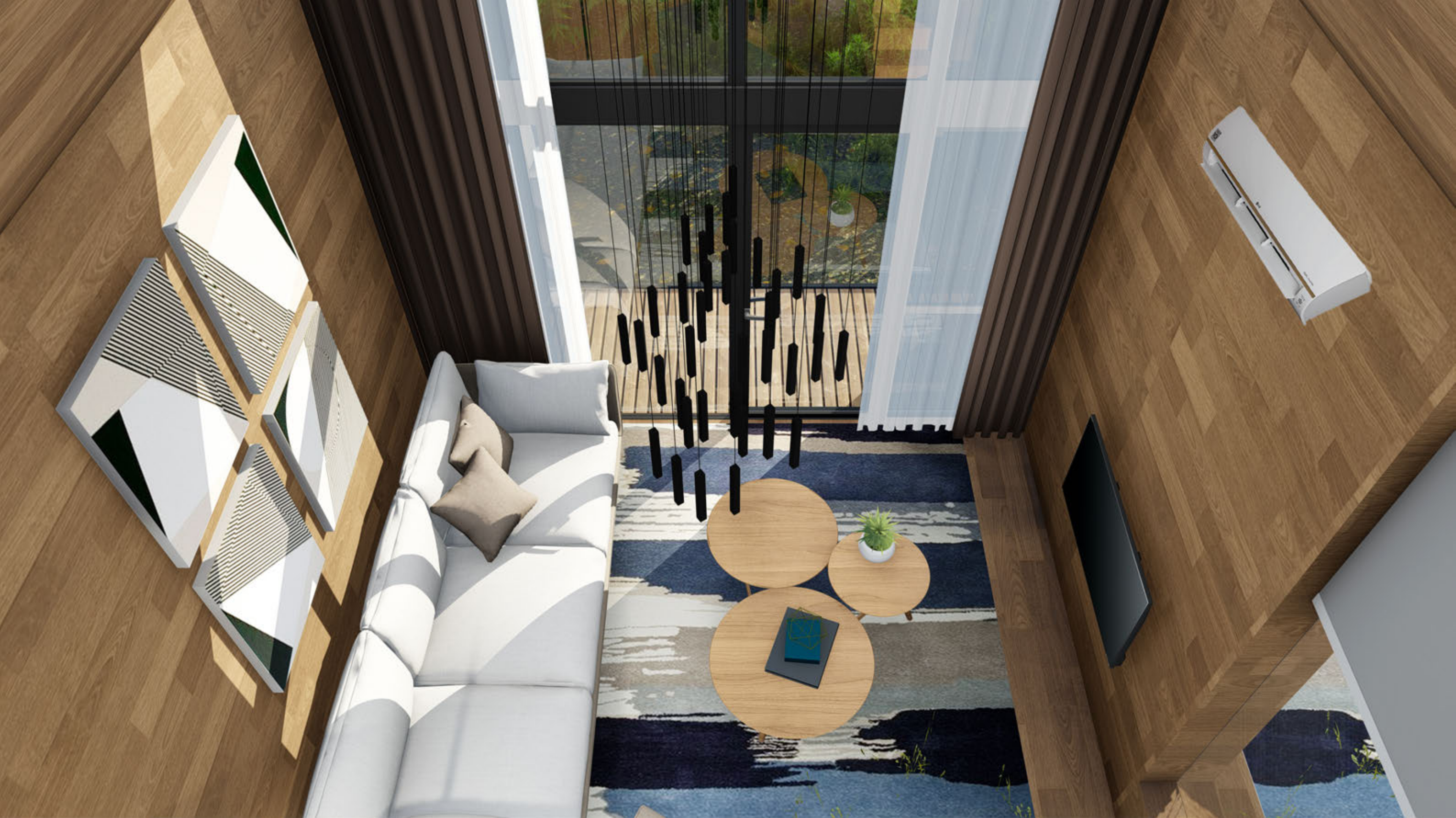

### **SPACE TO ENJOY**

The loft with a floor height of around 5.6 meters and the second floor being an independent bedroom. Taking up 50+ square meters, there is plenty room left for activities





### EXTRAORDINARY VIEW

You can cozily lay bedside and see endlessly through the 180 degree luxurious panoramic skylight or its large floor to ceiling double-pane insulated windows.





## SECURITY

Mirrored cladding used on the evo 3 are all double-layer laminated ultra strong tempered glass. The 200mm thick heat preservation walls not only endows enough rigidity but also have impressive sound and heat insulation performance.





## EXTREME COMFORT

Comfort is a major feature of the evo 3. equipped with independent toilet and shower, as well as kitchen, evo 3 is the perfect pick for you and your family, as home or cabin away from home.





8700

4000

5600

Exclusively sold & marketing by EPL Developments  
PT. Evolusi Persona Lestari ( Bali)

Precision - Sustainable - Anywhere

\*Resort White Option



Living Area : 60 sqm (645.92 sq ft) + Loft  
\*Land Lot : 100 sqm / 1076 sq ft.

1 Living room . 1 Bathroom . 1 Loft Bedroom  
1 Kitchen . 1 Balcony . 4P REC Solar Roof Grid

Build Application: lakeside, mountain side,  
hilly area, highlands, flatlands, woods /forest



evo 3

8700

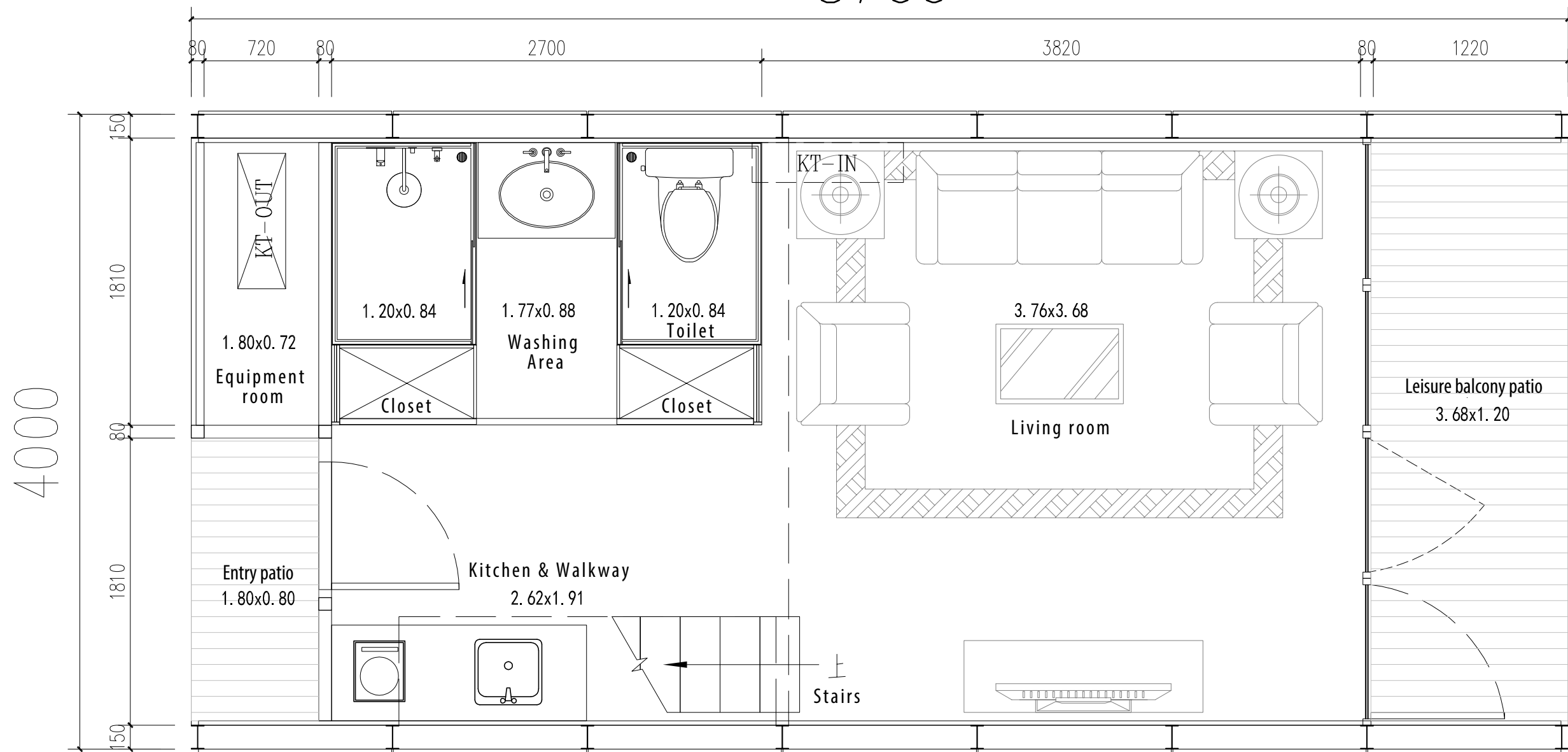

PLAN OF FIRST FLOOR



evo 3

8700

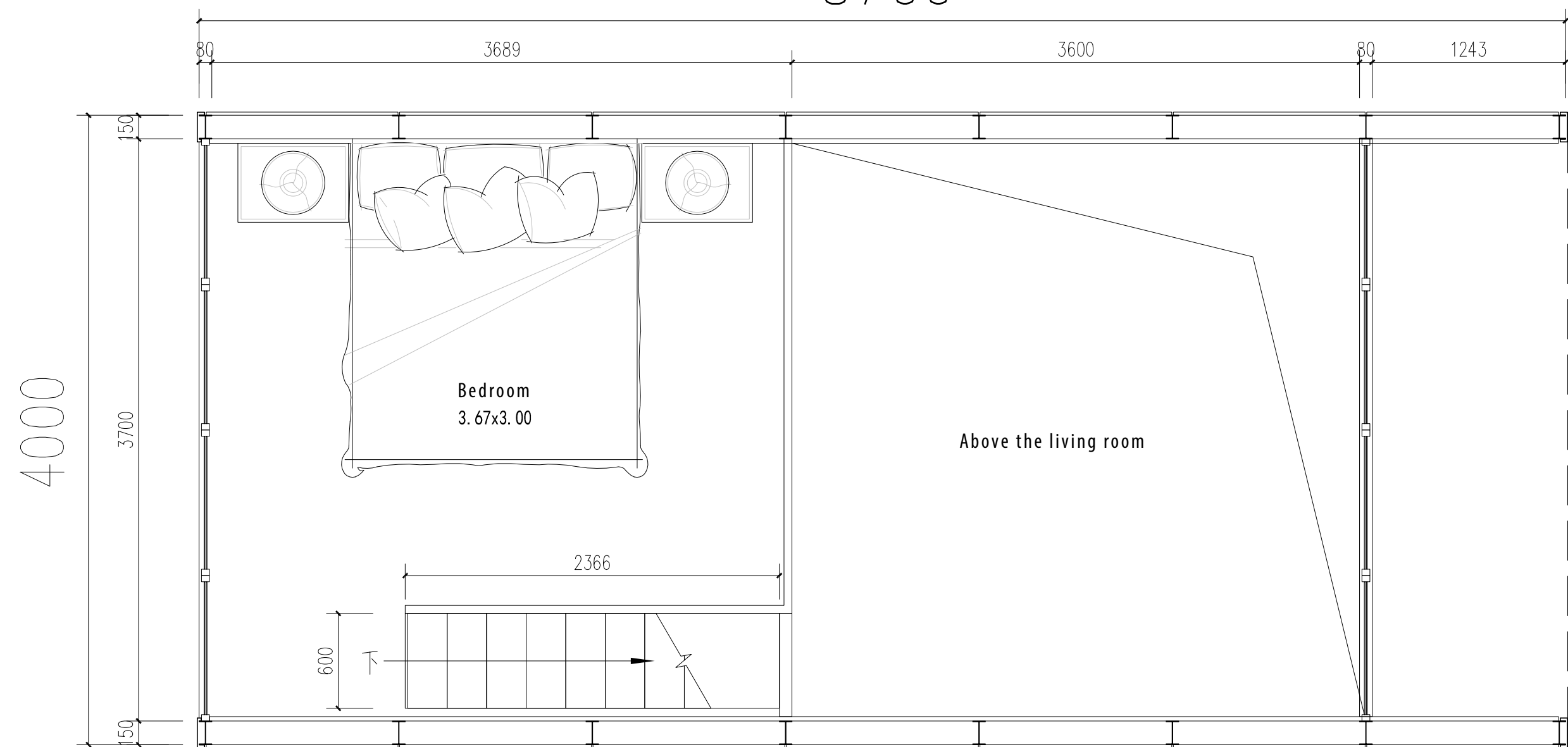

PLAN OF SECOND FLOOR



CONFIGURATION EVO 3

Categories	Configurations	Brands	Standard	Lux+
Frameworks	patented aviation aluminum framework system		●	●
	patented connection locks		●	●
External walls	Double-layer laminated outdoor tempered mercury mirrors	Galuminum	●	●
	Multi-layer advance complex integrated walboard w/ built in thermal insulation (all weather)		●	●
Internal walls	Multi-layer complex integrated walboard with heat preservation and insulation functions		●	●
Doors&windows	double pane thermal tempered glass		●	●
	Curtain windows made of tempered glass		●	●
Floor	Composite baseplates		●	●

Bathroom	Wash Sink	TOTO	●	●
	Independent shower	TOTO	●	●
	Shower head package	TOTO	●	●
Kitchen	Integrated cupboard		—	○

Water heater	Water heater (Germany)	STIEBEL ELTRON	—	○
Air conditioning	AC Dual Cool SMART Eco Inverter 2PK	LG	—	○
Ventilation system	Ventilation	Renowned brand	—	○
Television	LG Smart ULTRA 43" HD		—	○
Smoke exhauster	Smoke exhauster		—	○
			—	○
			—	○
Induction cooker	Induction cooker	FRANKE	—	○
			—	●

Intelligence system	Smart door lock	SAMSUNG	—	○
	Intelligent gateway		—	○
	Intelligent sensor		—	○
	Intelligent switch		—	○
	Intelligent background music system		—	○
	Intelligent safeguard system		—	○
	Intelligent hotel management system		—	○
			—	○

Categories	Configurations	Brands	Standard	Lux+
Stair system	Integrated stairs	EPL	●	○
Handrail	Handrail	EPL	●	○
Wall decoration	One-piece wood finish		●	○
Equipment room	Integrated equipment room	evo	●	○
Skylight	Skylight		●	○
Outdoor leisure platform	Outdoor leisure platform		—	○
Lamps	Simple bed lamps		—	○
	Ceiling lamp		●	○
	Bathroom lamps		●	○
	Entrance lamps		●	○

Furniture	Standard bed frame	Kobeks	—	○
	Standard queen size bed	Big Koko	—	○
	Sofa bed		—	○
	Leisure Chair		—	○
	Coffee Table		—	○
	Multi-functional integrated desk & chair		—	○
	Locker		—	○
	Carpet		—	○
	Electric curtain motor		—	○
	Curtain / sheer		—	●
	Privacy window blinds		—	●
* The above options are for reference only. ●Included ○Excluded				

\*Luxury Edition request price list.



For up-to-date options and pricelist, resort options.

www.evosuites.com



## All Weather Ready





## \*Optional Interior Colors





## **evo** \*Hybrid Prefab/ Modular Suites & Home

- \* Ideal for short term land use \*leases land
- \* Temporary Housing Solutions
- \* Short term & Long Term Low Cost Turn-Key Housing Option
- \* Transportable \*Relocatable
- \* Off Plan preDesigned unites ready in 90 days or less
- \* Can be delivered anywhere in South East Asia or North America, Europe
- \* 10 Year Building & Workmanship warranty
- \* 3 Year Warranty on Appliances & Electrical
- \* 10 Year LG Dualcool AC inverter \*compresor warranty
- \* 25 Year Solar panel product and performance
- \* 12 Year Solar inverter product warranty
- \* Local Installation Services provided in 25 Countries \* Inquire for more details

### **Performance & Integrity & Lifespan**

= Class 8 earthquake resistance, anti-typhoon 12, anti-noise 68DB, fire A grade, service life 50 years

**PT. EVOLUSI PESONA LESTARI**  
Nakula Plaza, Jl Nakula, Legian  
Kuta, Bali 80361  
[ask@evolutionsuites.com](mailto:ask@evolutionsuites.com)  
[www.evolutionsuites.com](http://www.evolutionsuites.com)



**PRECISION . SUSTAINABLE . ANYWHERE**

***evosuites.com***



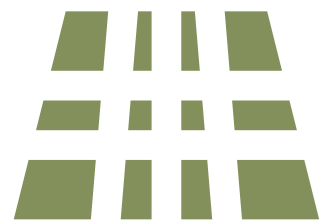

evo SUITES

*evosuites.com*

PRECISION . SUSTAINABLE . ANYWHERE

Vision Partners :      